

## Reduced Union

(10/pack)

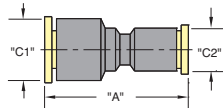

Tubing	Part No.	"A"	"C1"	"C2"
5/32"-1/8"	<a href="#">PQ-RU0504</a>	1.230"	0.410"	0.410"
6 mm*-5/32"	<a href="#">PQ-RU06M05</a>	1.367"	0.524"	0.410"
1/4"-1/8"	<a href="#">PQ-RU0804</a>	1.367"	0.524"	0.410"
5/16"-1/4"	<a href="#">PQ-RU1008</a>	1.550"	0.580"	0.524"
3/8"-1/4"	<a href="#">PQ-RU1208</a>	1.666"	0.720"	0.524"
1/2"-3/8"	<a href="#">PQ-RU1612</a>	1.810"	0.850"	0.720"

## Y Union

(5/pack)

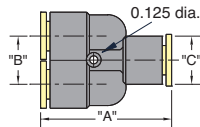

Tubing	Part No.	"A"	"B"	"C"
1/8"	<a href="#">PQ-YU04</a>	1.340"	0.415"	0.410"
5/32"	<a href="#">PQ-YU05</a>	1.318"	0.517"	0.410"
6 mm*	<a href="#">PQ-YU06M</a>	1.495"	0.531"	0.524"
1/4"	<a href="#">PQ-YU08</a>	1.495"	0.531"	0.524"
5/16"	<a href="#">PQ-YU10</a>	1.495"	0.590"	0.580"
3/8"	<a href="#">PQ-YU12</a>	2.017"	0.720"	0.720"
1/2"	<a href="#">PQ-YU16</a>	2.070"	0.840"	0.840"

## Reduced Branch

(5/pack)

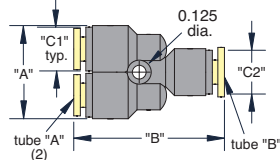

Tube "A"	Tube "B"	Part No.	"A"	"B"	"C1"	"C2"
1/8"	5/32"	<a href="#">PQ-RB0504</a>	0.830"	1.340"	0.420"	0.410"
5/32"	1/4"	<a href="#">PQ-RB0805</a>	0.830"	1.390"	0.410"	0.524"
1/4"	5/16"	<a href="#">PQ-RB1008</a>	1.025"	1.670"	0.524"	0.580"
1/4"	3/8"	<a href="#">PQ-RB1208</a>	1.025"	1.780"	0.524"	0.720"
3/8"	1/2"	<a href="#">PQ-RB1612</a>	1.420"	2.050"	0.720"	0.850"

## Tee Reducer

(5/pack)

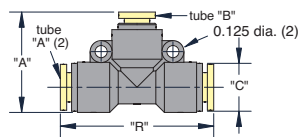

Tube "A"	Tube "B"	Part No.	"A"	"C"	"R"
5/32"	1/8"	<a href="#">PQ-TR0504</a>	0.910"	0.410"	1.385"
1/4"	5/32"	<a href="#">PQ-TR0805</a>	1.050"	0.524"	1.570"
5/16"	1/4"	<a href="#">PQ-TR1008</a>	1.170"	0.580"	1.835"
3/8"	1/4"	<a href="#">PQ-TR1208</a>	1.380"	0.720"	2.160"
1/2"	3/8"	<a href="#">PQ-TR1612</a>	1.600"	0.850"	2.240"

## Elbow Reducer

(5/pack)

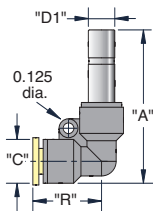

Tubing	Part No.	"A"	"C"	"D1"	"R"
1/8"	<a href="#">PQ-ER0405</a>	1.480"	0.420"	5/32"	0.710"
5/32"	<a href="#">PQ-ER0508</a>	1.640"	0.410"	1/4"	0.722"
1/4"	<a href="#">PQ-ER0810</a>	1.765"	0.524"	5/16"	0.840"
5/16"	<a href="#">PQ-ER1012</a>	2.020"	0.580"	3/8"	0.880"
3/8"	<a href="#">PQ-ER1216</a>	2.260"	0.720"	1/2"	1.100"

## Plug-In Elbow

(5/pack)

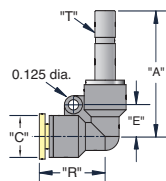

Tubing	Part No.	"A"	"C"	"E"	"R"
1/8"	<a href="#">PQ-PE04</a>	1.290"	0.410"	0.328"	0.722"
5/32"	<a href="#">PQ-PE05</a>	1.290"	0.410"	0.328"	0.722"
1/4"	<a href="#">PQ-PE08</a>	1.550"	0.524"	0.370"	0.840"
5/16"	<a href="#">PQ-PE10</a>	1.600"	0.580"	0.430"	0.900"
3/8"	<a href="#">PQ-PE12</a>	1.850"	0.720"	0.472"	1.100"
1/2"	<a href="#">PQ-PE16</a>	1.940"	0.850"	0.570"	1.160"

## Tube Reducer (Stem)

(10/pack)

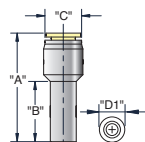

Tubing	Part No.	"A"	"B"	"C"	"D1" Dia.
1/8"	<a href="#">PQ-TRS0405</a>	1.320"	0.690"	0.410"	5/32"
5/32"	<a href="#">PQ-TRS0508</a>	1.400"	0.810"	0.524"	1/4"
1/4"	<a href="#">PQ-TRS0810</a>	1.480"	0.850"	0.580"	5/16"
1/4"	<a href="#">PQ-TRS0812</a>	1.610"	0.990"	0.720"	3/8"
3/8"	<a href="#">PQ-TRS1216</a>	1.730"	0.990"	0.850"	1/2"

\* Fittings have a green release button.

Note: Fittings with pipe thread NPT, R1/8, R1/4 and R3/8 are supplied with pre-applied sealant.